

Kiosk Setup Guide

The diagram below shows the cables and connections required to set up the Ocean Kiosk.

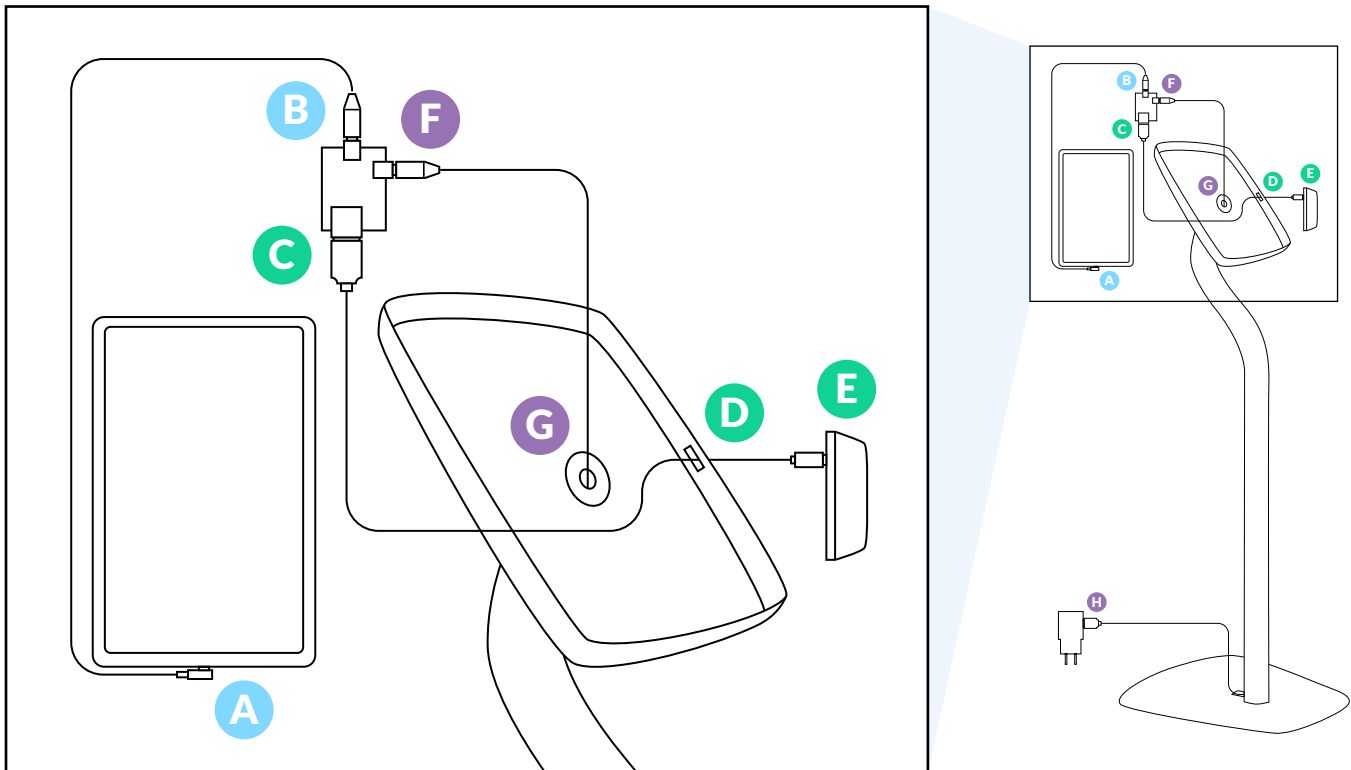

Short cable that comes with the SimulCharge connector (USB-C to USB-C)

- A** Plug the USB-C right angle connector into the Tablet.
- B** Plug the other USB-C into the USB-C SimulCharge connection port on the shorter edge.

Medium length cable that comes with the reader (microUSB to USB)

- C** Plug the standard USB into the USB SimulCharge connection port on the shorter edge.
- D** Pull the cable through the mounting plate of the kiosk.
- E** Plug the microUSB into the reader. This one can be fussy and needs to be fully pushed into the reader.

Long cable (USB-C to USB)

- F** Plug the USB-C into the USB-C SimulCharge connection port on the longer edge.
- G** Run the cord down the stand leg and out the opening by the floor.
- H** Plug the standard USB into the Samsung charging block. Make sure the Samsung charger is plugged into a working outlet.

Next Steps

Visit www.CognisantMD.com/configure-kiosk-tablet for current instructions on how to set up your tablet for use in your Ocean kiosk.



Web www.CognisantMD.com
Phone (888) 864-8655
Email info@cognisantmd.com